

LAY OUT MATERIALS

WOOD PARTS

A

Slatted Wood Board (12)
 $\frac{5}{8}$ " x $4\frac{1}{2}$ " x $38\frac{1}{4}$ "

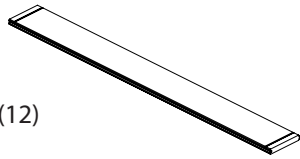

B

Top Wood Board (1)
 $\frac{5}{8}$ " x $4\frac{1}{2}$ " x $38\frac{1}{4}$ "

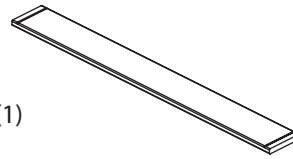

C

Wood Spacer (2)
 $\frac{5}{8}$ " x $1\frac{1}{4}$ " x $3\frac{7}{8}$ "



D

Wood Block (1)

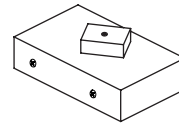

LARGE PARTS

E

Right Post Top (1)
 $1\frac{1}{4}$ " x $1\frac{1}{4}$ " x $24\frac{1}{8}$ "

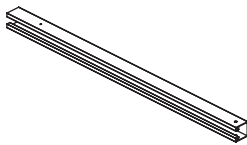

Bottom view

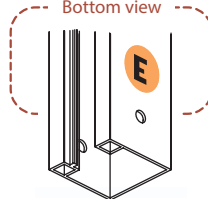

F

Left Post Top (1)
 $1\frac{1}{4}$ " x $1\frac{1}{4}$ " x $24\frac{1}{8}$ "

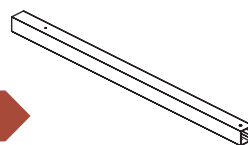

Bottom view

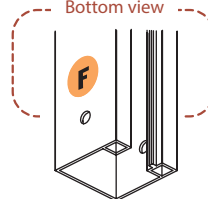

G

Right Post Bottom (1)
 $1\frac{1}{4}$ " x $1\frac{1}{4}$ " x $36\frac{3}{8}$ "

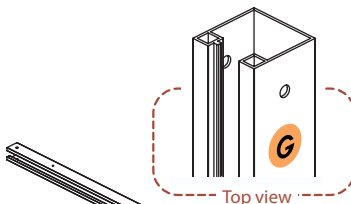

Top view

H

Left Post Bottom (1)
 $1\frac{1}{4}$ " x $1\frac{1}{4}$ " x $36\frac{3}{8}$ "

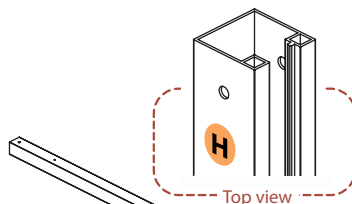

Top view

I

Ground Stake (2)
 $\frac{7}{8}$ " x $1\frac{1}{8}$ " x $23\frac{1}{2}$ "

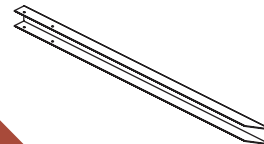

WOOD PARTS

J

Post Bridge (2)
 $\frac{7}{8}$ " x $1\frac{1}{8}$ " x $6\frac{1}{2}$ "

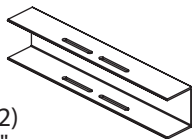

K

Post Cap (2)

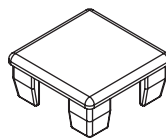

L

Joiner Clip (2)

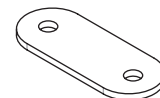

SCREWS

M

1" Self-Drilling Stainless Steel Screw (12)



N

$\frac{1}{2}$ " Wide Head Stainless Steel Screw (8)

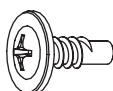

TOOLS

O

$\frac{1}{8}$ " Drill Bit (1)

